

REVLON® Lashes with featherLITE™ TECHNOLOGY

HOW TO APPLY Revlon® Individual Lashes

Individual lashes are a great way to enhance and customize your natural lashes. Here is what you will need to create a beautiful customized eye look:

- Revlon® individual lashes
- Tweezers
- Revlon® Precision Lash Adhesive

Apply all eye make-up, including mascara, prior to applying the individual lashes.

Gently remove individual lash from tray with a tweezer.

Apply the Revlon precision lash adhesive on the individual lash, and wait a few seconds until adhesive becomes tacky.

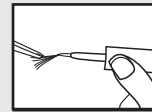

While looking down place individual lash as close to your lash line, starting from the outer corner of your eye, and then work your way in, pushing individual lashes gently in place with your finger. I'm creating a flare look using 2 long and then 2 medium lashes. Repeat on other eye. You now have stunning, lightweight lashes that are flutterly perfect.



WE'VE GOT YOUR LASHES™! Revlon has a variety of lash styles to fit every occasion and for the first time, you can try them on in stores. Find the try me feature on the side of the Revlon lash packaging and place in front of your right eye and look in the mirror.